



GPAERO

Machining & Metal Treatments



OUR CORPORATE



EXPERIENCE
+30 YEARS



14
COMPANIES



+2000
EMPLOYEES



7 PLANTS
IN MEXICO

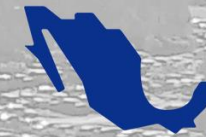

NATIONAL
PRESENCE



INTERNATIONAL
CLIENTS

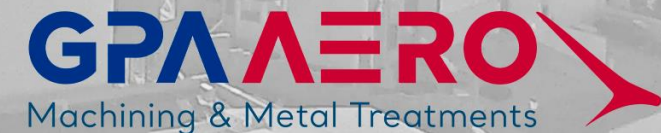

ABOUT US

We are a specialized company in providing solutions and services to the industry through high precision machining and metal finishings.

We satisfy the needs of our customers by using advanced technology, high quality standards and innovative processes.

INDUSTRIES WE SERVE



AUTOMOTIVE



AEROSPACE



OIL & GAS



MEDICAL



GPA AERO
Machining & Metal Treatments



MONTERREY

 **Capabilities:** Machining & High Volume Raw Material Warehouse

 **+ 6 Turning & Machining Centers**

 Parque la Puerta 3
Av. Las Torres 1533 Bodega H
Col. Regio Parque Industrial
Sta. Catarina, NL
CP 66367

CHIHUAHUA

 **Capabilities:** Machining & Metal Treatments

 **+ 17 Turning & Machining Centers**

 **+ 3 Surface Treatment Production Lines**

 C. Sicomoro 2905
Col. Francisco I. Madero
Chihuahua, CHIH
CP 31105

GENERAL OVERVIEW

 **+ 55 Employees**

 **+ 4 M USD Revenue**

 **+ 3,400 m² Space Availability**

 **2 Production Shifts**

 **ISO9001:2015**

 **AS9100**

 **NADCAP METAL TREATMENTS**

 **IMMEX**



FACILITY



**REVERSE
ENGINEERING**



**CMM
METROLOGY LAB**

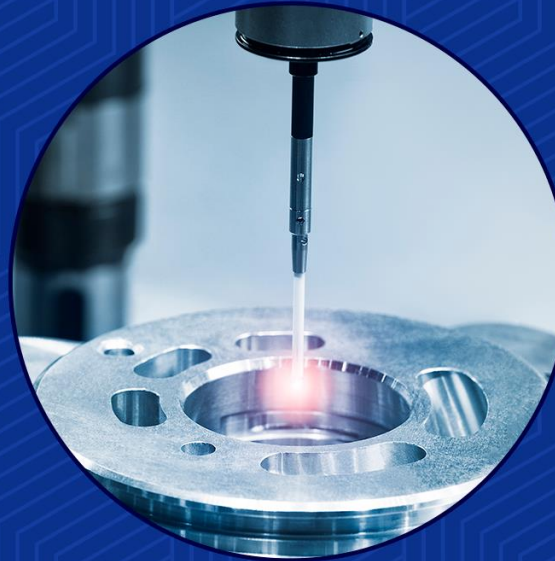

**CNC
EQUIPMENT**

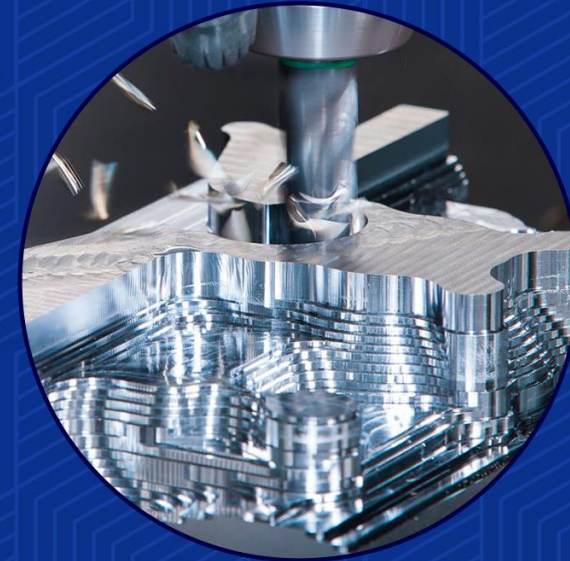

**LOW VOLUME/
HIGH MIX**

**QUALITY
STANDARDS**

**HIGH
PRECISION**

RELIABILITY

**HIGH
VOLUME**

FIVE AXIS

MACHINING CAPABILITIES

SURFACE FINISHINGS

- ANNOZING
- PASSIVATION
- CHELM FILM
- ALUMINUM EDGE

NON DESTRUCTIVE TESTS

- FLOURESCENTE PARTICLE INSPECTION (FPI)
- SALT SPRAY TEST

LINE 1

- L4200MM X W750MM X H1250MM(3,900 L)

LINE 2

- L1220MM X W1220MM X H110MM (1,600L)

LINE 3

- L480MM X W480MM X H510MM (150L)



SURFACE FINISHING CAPABILITIES

OUTSOURCED CAPABILITIES

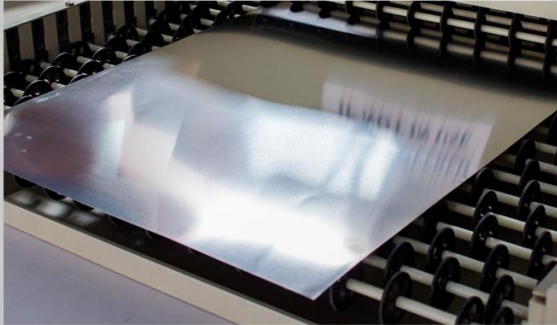

HEAT TREATMENT:

TEMPERING & QUENCHING
NORMALIZING
CEMENTATION
NITRIDED
NITRO-CARBURIZED
STRESS RELIEVING
ANNEALING

PAINTING

SHEET METAL

METAL FINISHING:

ZINC
PHOSPHATING
BLUEING
GALVANIZING
ELECTROPOLISHING

SORTING & INSPECTION

CUSTOMERS

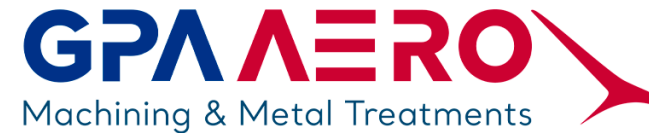

MAIN DESIGN PLATFORM: SIEMENS NX



- Design
- 3D Modeling
- 2D Drawing
- Multi Axis Machining, Turning
- CAM and Post Processor

COMPUTER AIDED DESIGN & COMPUTER AIDED MANUFACTURING

MAIN PROJECTS

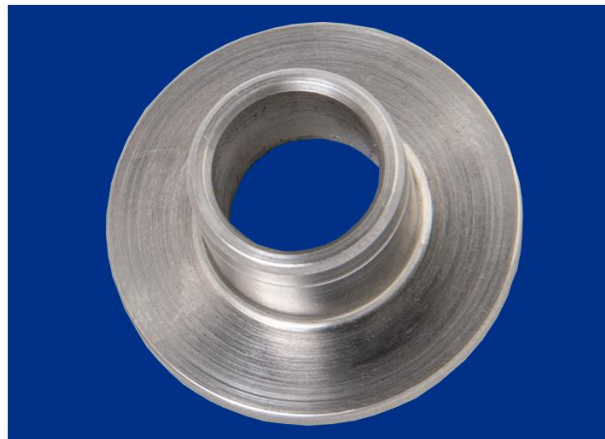
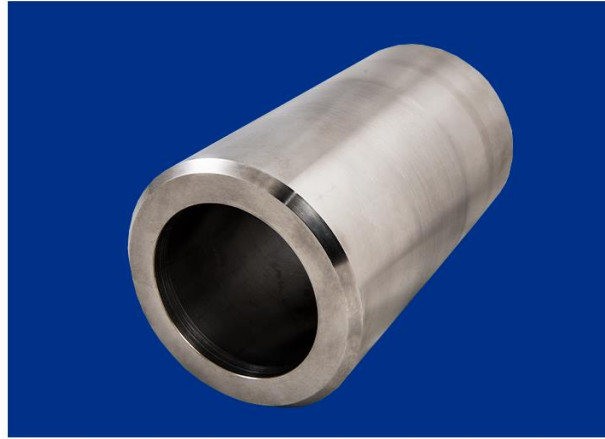

MAIN PROJECTS

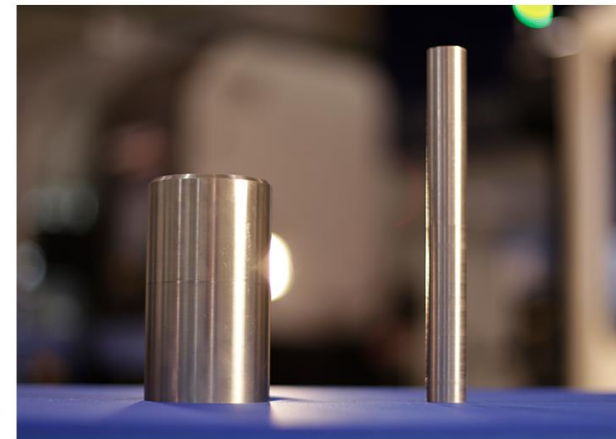
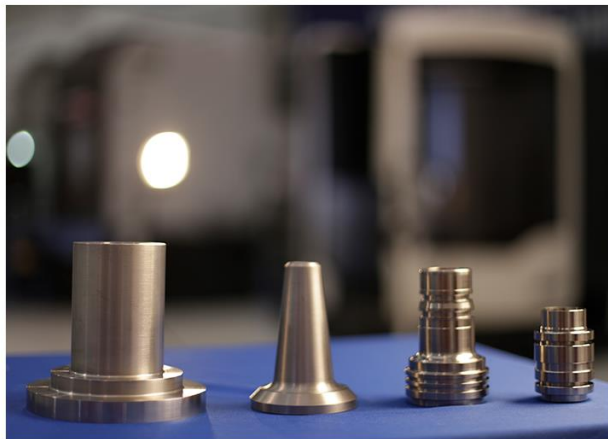

MACHINERY & EQUIPMENT

Request "Equipment List File" for complete and detailed information





INSTANT MEASURING SYSTEM
KEYENCE IM 3020



BRIDGE CMM
BRIDGE CMM
LK ALTERA C 10.7.5



VISION MEASURING MACHINE
HEXAGON
OPTIV CLASSIC 3.2.1



ARM CMM WITH INTEGRATED SCANNER
ARTICULATED ARM COORDINATE
MEASUREMENT MACHINE WITH OPTICAL
DISTANCE SENSOR MODEL 7725SEI

METROLOGY LABORATORY

CERTIFICATES & DISTINCTIONS

Approved Supplier

Honeywell
Aerospace



BY D.N.V.

Certificates





LET US BE YOUR PARTNER

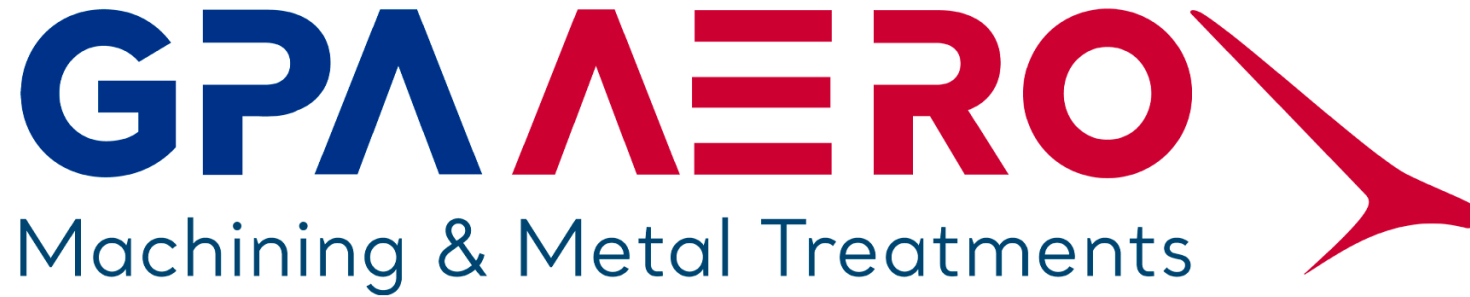

CONTACT US

CHIHUAHUA

 sales.cuu@gpaaero.com

 614 417 5492

 614 352 0069

MONTERREY

 sales.mty@gpaaero.com

 811 089 51 04

 811 959 39 69

